



*First choice when
quality counts.™*

Ultra® Max Electronic Airless Sprayers



**Maximum
Productivity.
Maximum
Results.**

Get Graco. Experience The Difference.™

PACKAGES



The Quality Difference.

Graco's quality difference for over 70 years has been to exceed the industry standard in design and manufacturing of every component. Our 49+ person engineering staff is progressively designing technologically superior products on sophisticated Computer-Aided Design equipment and performing extensive field tests. Once field tests are complete, each component then goes through rigorous testing to ensure each and every sprayer performs to its maximum life and performance.

In addition, our manufacturing staff ensures all sprayers pass the most intensive quality tests. In fact, the expansive manufacturing facility is equipped with state-of-the-art computerized machinery for exact tolerances and consistent quality so nothing leaves the factory until it's in perfect working condition. So even though you can't always see the Graco quality difference, it's in there!

Maximize Pump Life

Graco, the leader in airless paint sprayer design introduces the most revolutionary improvements to the piston pump since we began making them!

- **Maximum packing & pump life**
- **Simple design**
- **Exceptional performance with heavier coatings**
- **Easy maintenance**

The Endurance Piston Pump sprays up to thousands of gallons more than our nearest competitor's sprayer before needing repacking!*

Automatic Adjusting Piston Packing

Piston packings ride on the rod. Simply install piston stud and packing tension is accurately set.



NEW Endurance Piston Pump™ Defining a new standard for pumping technology!

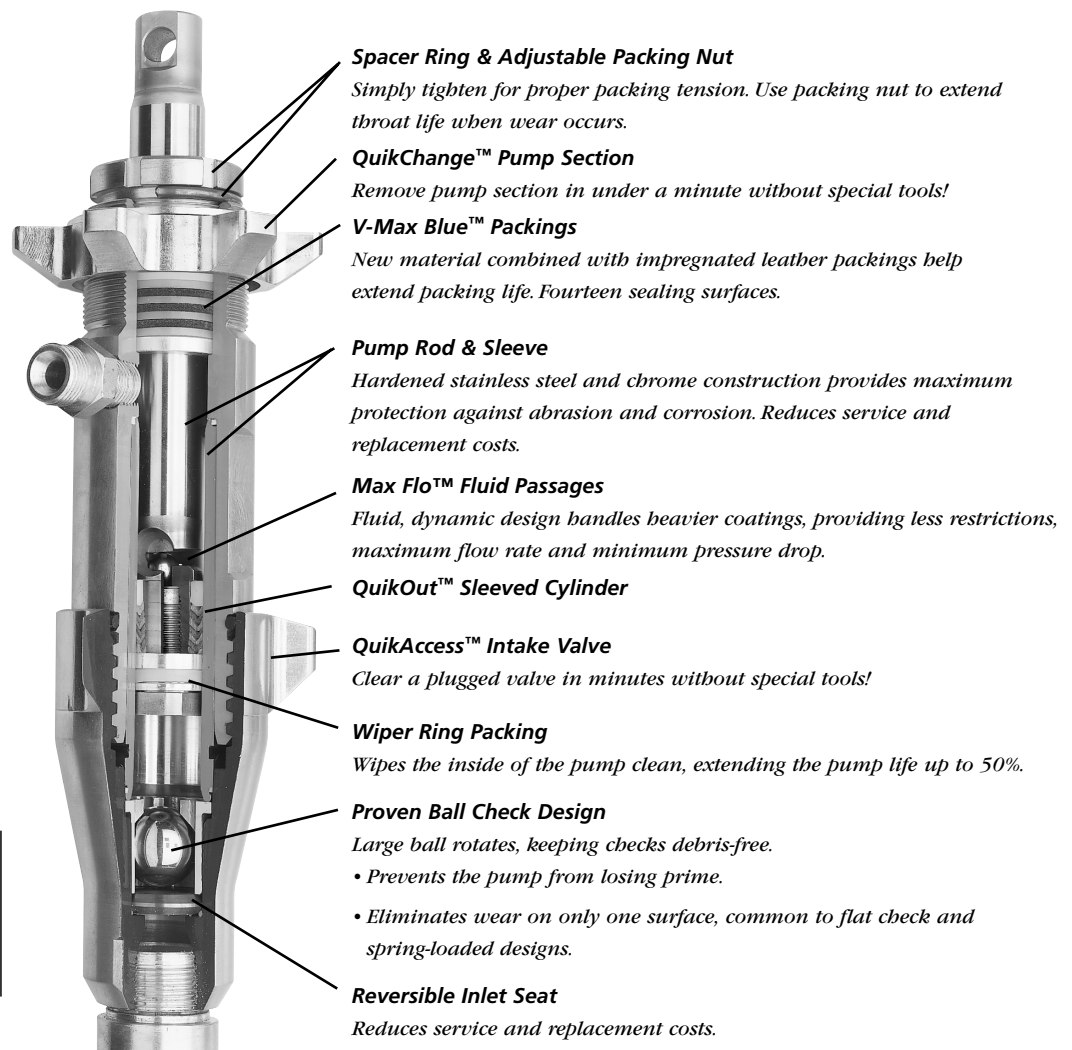

* Actual performance depends on model and material usage. Latex paints were used during life tests.



The Quality Inside.

Motor Brushes are easy to replace and service in the field. Larger brushes than competitive models for longer life.

DC Motor industrial grade, permanent magnet, totally-enclosed, fan-cooled design.

18 sq in. Manifold Filter eliminates large contaminants in material for less tip clogs. Also helps produce a higher quality finish.

Heavy-Duty Gears are permanently lubricated and case-hardened for reliable operation and maintenance-free use.

Maximize Your Pressure Control

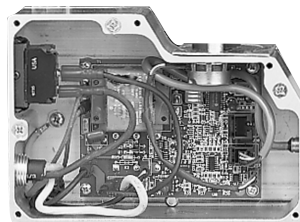

SmartControl™ Processor

Graco's patented SmartControl Processor provides increased accuracy and precise soft-start electronics for smooth, consistent spraying pressure when triggering.

- Monitors everything from inbound power to motor running speed & temperature. This controls the system, assuring maximum sprayer performance.
- Consistent mil build, one-pass spray coverage
- Spray at low or high pressures without pattern fluctuations
- Better atomization of hard-to-spray coatings
- Run multiple guns and longer hose lengths
- Freeze-Damage Resistant
- Modular Design for easy service and lower replacement costs
- Provides spray pressure from 200 psi (14 bar, 1.4 MPa) to 3000 psi (210 bar, 21.0 MPa)

SmartControl Processor Electronic Pressure Control

Integrated Filter Assembly*
Less connector fittings for improved fluid flow with less pressure drop for better spraying performance.

Large 3/8 in. Fluid Outlet*
Allows use of 3/8 in. x 3/8 in. fitting for improved material flow and reduced pressure drop. Comes standard with 1/4 in. outlet male fitting.

Endurance Piston Pump™
Patent pending design.

Hi-Flow Filter Base*
Large dual flow passages improve fluid flow and reduce pressure drops for better spraying performance.



Heavy-Duty Steel Fluid Filter Bowl
Easy-to-grip design with increased durability.

* Standard on all models except Ultra Max 695.



"We've sprayed a couple thousand gallons of paint with the new Ultra Max Sprayer — blockfillers, elastomerics and a lot of latex. I'm extremely pleased with its performance. The new piston pump section works great too. It is easy to service and, if needed, you can get at the lower ball very quickly. The new filter bowl design makes it easy to grip and take off. I've never had to use a wrench to remove it."

Jay Kaser, President
Kaser Painting, Inc.
Lincoln, NE



The Warranty Difference.

We build it. We back it. Period.

Because of our industry leading quality design and performance, we're able to offer the best overall warranty in the industry. This allows you to buy with confidence and gives you the lowest, long-term cost of operation, highest resale value and maximum performance.

Our warranty is also easy to use - there's no complicated paperwork. This warranty is in addition to the standard Graco Warranty* described in the instruction manual. What you see is what you get!

2-Year Bumper-to-Bumper Warranty

For 2 years, Graco will repair or replace any defective or worn out bare sprayer component for the original owner. Each fluid pump component is limited to a one-time wear replacement. This warranty does not cover consumable items such as filters, cup liners, TSL, etc.

Lifetime Warranty on Gear Train & Electric Motor

The original owner is promised a lifetime warranty on the gear train and electric motor (excluding brushes)

30-Day "Just Add Paint" Satisfaction Guarantee

If you're dissatisfied with the performance of a Graco Sprayer, simply return it within 30 days to the place of purchase. You can exchange it for an identical unit. Or, if you'd prefer, trade-up to a larger unit, requiring an additional cost.

Highest Resale Value

When you purchase a new sprayer, it's important to consider the long-term resale value. Clearly, you'll see a difference with Graco equipment. Graco Sprayers typically offer a 20% to 30% higher resale value than the closest competitive brand.

Downtime Eliminator™ Program

Graco's large distributor network offers you parts or service in almost every city throughout North America. If the warranty part you need is not in your distributor's stock, Graco offers FREE overnight, next business day delivery, when your distributor orders by 2 pm Central Standard Time. Plus, our Quik-Parts Plus Program offers over 250 parts 100% in stock at all times.

Large Distributor Network

440+ conveniently located, authorized and certified service centers and 5400+ distributor locations stand behind Graco products. Trust these experts to provide quick, reliable service with genuine Graco parts, accessories and sprayers in stock.

Assistance is just a phone call away

1-800-690-2894 for Customer Service

** Outside of the United States and Canada, not all conditions of the extended warranty may apply. Contact your local distributor for complete details.*

The Performance Difference.

Ultra Max Sprayers deliver the best atomizing pressure for your coatings. Graco defines spraying performance by the actual spray tip size the unit will support with latex paint.

Perform to the Max with Higher Spraying Pressures:

- Spray a wider range of coatings, expanding your job opportunities
- Less thinning of coatings required
- Improved cold weather spraying
- Longer hose lengths can be used, saving labor time



PACKAGES

Unmatched Spray Pressure Consistency

Higher output & more consistent spraying pressure.

- Uniform coverage
- More consistent mil build
- Saves material & time
- Superior quality finish

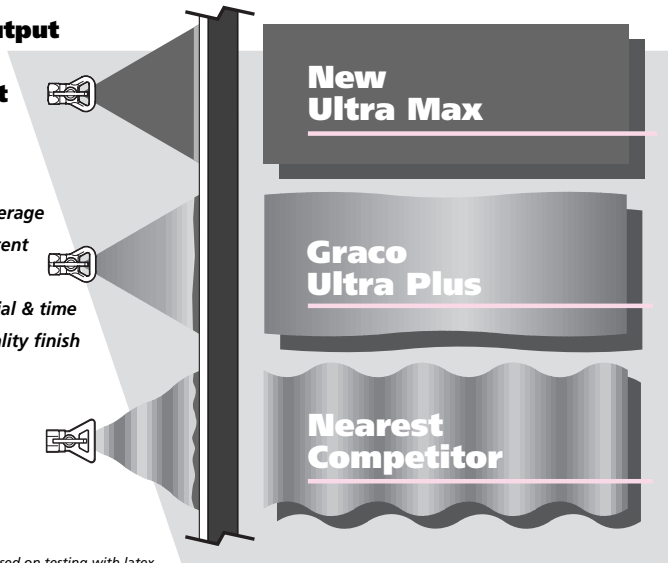

Illustrated results based on testing with latex paint and 0.019 in. tip.

- Up to 30% better pressure control consistency than the nearest competitor
- 10% improvement over Ultra Plus Models

Maximize Motor Performance

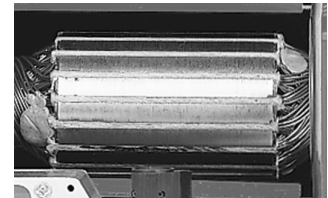

Longest Life DC Motor designed to Graco's specifications

- Offers longest life and reliability under tough job site conditions
- Variable speed, industrial grade, with permanent magnets
- Totally-enclosed, fan-cooled motor protects motor from contaminants
- Rated motor life up to 7 times longer than competitive models
- Adapts to voltage fluctuations without producing extra heat which can trip circuits or damage other types of motors
- Works on demand - shuts off when you stop spraying, saving wear on motor, pump and other sprayer components
- Multiple users can operate from one power source if necessary
- Operate off lower amp circuits
- Run off temporary power and handle long extension cords

Maximum Pump Life

Spray 1000 to 4000 additional gallons (3800 to 15,000 liters) before repacking compared to the nearest competitor... That's twice the life!



New Ultra Max with Endurance Piston Pump

Gallon for gallon, the Ultra Max outlasts the competition.



Ultra Plus Models



Nearest Competitor

Ultra Max also offers on average 65% greater life than the Ultra Plus Line.

Illustrated life test results conducted on competitive electric-powered airless units with latex paint vs. Ultra Max. Actual performance varies by model.



The Features.

Maximize Productivity

These new features make your job easier, and a lot more productive! The Ultra Max is easy to use and offers quick and simple maintenance. From transport to clean-up, get the most out of your work day!

Maximize Reliability

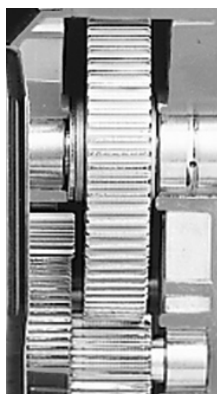

GEARS & DRIVE ASSEMBLY

Maintenance-free, case-hardened metal gears and drive assembly for maximum reliability ensure your sprayer is always up and running.

The drive system maximizes performance and minimizes motor wear by converting 95% of the usable horsepower from the motor into pumping energy!

Compared to belt drive or hydraulic systems, it's the most efficient.

Easy in-field or shop replacement!

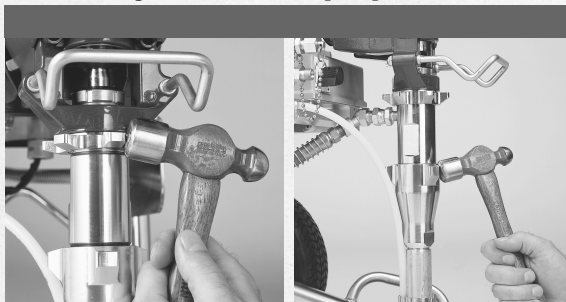

QuikChange™ Pump Section*

Removal in less than a minute with only a hammer, adjustable wrench and small screwdriver!

QuikAccess™ Intake Valve

Provides easy access to clear obstructions. Simply tap the flange,** loosen by hand and clear Intake Valve in minutes.



QuikFlo™ Outlet Plug

Extended stem keeps outlet fluid passage clear when not in use.

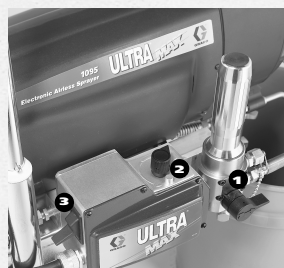

Convenient User Controls

1 Pressure Relief Valve

Positive positioning — select between spray or prime for minimal valve wear!

2 Pressure Adjustment Knob & Indicator Plate

Provides quick reference point for pressure settings.

3 Power Switch

Easily identify on/off position!

* Not available on the Ultra Max 695.

** Ultra Max 695 requires a wrench.



Designed for the Way You Work!

Many Ways To Wrap



Easy-to-Use, Larger Capacity Hose Rack

- Hi-Boys hold over 150 ft (46 m)
- Lo-Boys hold over 100 ft (30 m)

Retractable Handle

Allows easy hose removal on Hi-Boy models and convenient storage.



Hose Strap

Secures hose for transport.



Power Cord & Wrap

Standard 15 ft (4.6 m) cord reaches outlets without an extension — longest on the market!

Lift Handles

Make loading and unloading easy!

Easily transports a material container.



Hi-Boy Pail Hook

Lo-Boy Handle Design



PACKAGES

"I've been using the Ultra Max 695 with a variety of different coatings including stains. The results have been excellent. It's quiet and provides very consistent pressure control. I especially like the pressure control knob which makes it easy to identify where the pressure setting is in the range. The new hose rack makes it easy to coil the hose and the hose strap does a good job of securing it to the sprayer."

Keith Hagen, Owner
Precision Home Painting
Minneapolis, MN





Maximize Filtration

HELPFUL HINT

Proper filtration helps prevent downtime, the more filtration, the better:*

1. Inlet Strainer

In the 1st stage, the inlet strainer, at the end of the siphon tube prevents foreign objects from damaging the pump.

2. Manifold Filter

The 2nd stage of the filtering process eliminates larger contaminants, which helps reduce tip plugging and provides a higher quality finish.

3. Gun Filter

During the 3rd stage, the gun filter ensures dried paint particles in the hose or contaminants in the material don't end up on your finish.

** Select the specific filter size based upon material being sprayed. Some heavy bodied materials may require filter screen removal.*

The Product.

Ultra® Max 695

- Ideal for residential and light commercial applications
- Spray stains, lacquers, oil base coatings and latex

232-130 Bare Sprayer, Hi-Boy
232-131 Complete Sprayer, Hi-Boy

232-132 Bare Sprayer, Lo-Boy
232-133 Complete Sprayer, Lo-Boy

Ultra Max 795

- Ideal for large residential, or light to medium commercial applications
- Occasional 2-gun use
- Offers 33% more output than the Ultra Max 695
- Spray stains, lacquers, oil base coatings, enamels, latex, blockfillers and high build materials

232-140 Bare Sprayer, Hi-Boy
232-141 Complete Sprayer, Hi-Boy





Ultra Max 1095

- Ideal for large residential, commercial, industrial and heavy maintenance
- Frequent 2-gun use
- Offers 37% more output than the Ultra Max 795
- Spray stains, lacquers, oil base coatings, enamels, latex, blockfillers and high build materials

232-150 Bare Sprayer, Hi-Boy
 232-151 Complete Sprayer, Hi-Boy

Ultra Max 1595

- Ideal for large residential, commercial, industrial and heavy maintenance jobs
- Excellent for daily 2-gun use
- Offers 14% more output than the Ultra Max 1095
- Spray stains, lacquers, oil base coatings, enamels, latex, blockfillers, elastomerics, mastics, epoxies and other high build materials

232-160 Bare Sprayer, Hi-Boy 232-162 Bare Sprayer, Hi-Boy, CSA Certified
 232-161 Complete Sprayer, Hi-Boy 232-163 Complete Sprayer, Hi-Boy, CSA Certified



“The Ultra Max 795 Sprayer works wonderfully. We spray 75-80 gallons (284-303 liters) a day right out of the bucket. The lift handles are extremely handy and the reinforced frame is great. On a job site, the power switch and controls use to be difficult to read when covered in paint. The new design of the Ultra Max eliminates this problem.

Previously I used Speeflo units, but because of the performance, dependability and durability of the Graco Sprayers, now I don't use anything else!”

Tom Probst, Owner
The Woodlands Painting Contractors
 Woodlands, TX



Recommendation Chart

The following is a recommended guide to selecting an Ultra Max Airless Sprayer. Always make sure the material you are spraying has been tested for compatibility with your sprayer, and be sure to consult your supplier for specific information.

	Material	Type of Application	Maximum Delivery Rating	No. Guns & Tip Sizes
Ultra Max 695	<ul style="list-style-type: none"> • stains, lacquers, oil base coatings and latex 	<ul style="list-style-type: none"> • residential and light commercial applications 	<ul style="list-style-type: none"> • .6 gpm (2.3 1pm) 	<ul style="list-style-type: none"> • 1 gun to 0.026 in. tip
Ultra Max 795	<ul style="list-style-type: none"> • stains, lacquers, oil base coatings, enamels, latex, blockfillers and high build materials 	<ul style="list-style-type: none"> • large residential, or light to medium commercial applications 	<ul style="list-style-type: none"> • .8 gpm (3 1pm) • 33% more output than Ultra Max 695 	<ul style="list-style-type: none"> • 1 gun to 0.028 in. tip • 2 guns to 0.019 in. tip
Ultra Max 1095	<ul style="list-style-type: none"> • stains, lacquers, oil base coatings, enamels, latex, blockfillers and high build materials 	<ul style="list-style-type: none"> • large residential, commercial, industrial and heavy maintenance 	<ul style="list-style-type: none"> • 1.1 gpm (3.8 1pm) • 37% more output than Ultra Max 795 	<ul style="list-style-type: none"> • 1 gun to 0.032 in. tip • 2 guns to 0.021 in. tip
Ultra Max 1595	<ul style="list-style-type: none"> • stains, lacquers, oil base coatings, enamels, latex, blockfillers, elastomers, mastics, epoxies and other high build materials 	<ul style="list-style-type: none"> • large residential, commercial, industrial and heavy maintenance jobs 	<ul style="list-style-type: none"> • 1.25 gpm (4.75 1pm) • 14% more output than Ultra Max 1095 	<ul style="list-style-type: none"> • 1 gun to 0.035 in. tip • 2 guns to 0.025 in. tip • 3 guns to 0.019 in. tip

Accessories

Airless Tips and Guards

RAC IV SwitchTip

221-XXX

- Most widely used reversible tip on the market
- Spray lacquers to mastics
- Available in over 100 sizes
- Handles pressures up to 4050 psi (279 bar, 28.0 MPa)

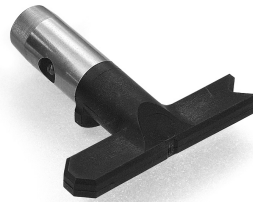

Fine Finish RAC Tip

FFR-XXX

- Exclusive two-stage atomization process creates a soft, feathered spray pattern
- Achieve a smooth, extremely fine finish with more consistent material thickness
- Spray lacquer, varnish, stain, high finish enamel or other fine finish coatings
- Handles pressures up to 3000 psi (210 bar, 21.0 MPa)

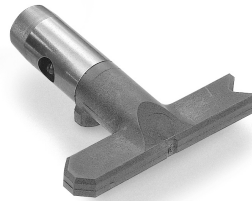

Performance Series™ DripLess™ Guard

237-859 For 7/8 in. (22 mm) Thread Size – Fits Graco and Titan Guns.

237-858 For 11/16 in. (17 mm) Thread Size – Fits Graco Pole Guns (older style) and Wagner Guns.

- Aerodynamic design directs material flow, creating a tighter, more consistent pattern while minimizing overspray
- Virtually eliminates paint build-up, dripping and spitting
- Backed by a 30-Day Satisfaction Guarantee



THE RIGHT COMBINATION

The combination of Graco Reverse-A-Clean (RAC) SwitchTips and Performance Series Guards gives you the best spraying performance possible.

- RAC SwitchTips are designed for easy tip unplugging & quick tip changes
- Broadest selection of the highest quality spray tips available
- All tips are manufactured with the highest quality tungsten carbide, tested for flow rate & liquid honed for longer life
- Performance Series DripLess Tip Guards offer a patented aerodynamic design which virtually eliminates dripping or material build-up
- Easily switch from one tip size to another
- No tools needed — with the latex gasket provided, quickly install RAC tip on any airless gun!

Gun Hose Kits

- Include Airless gun, RAC IV SwitchTip, DripLess Tip Guard, 1/4 in. x 50 ft (6.3 mm x 15.2 m) airless hose except 238-000 which has a 3/8 in. x 50 ft (9.5 mm x 15.2 m) airless hose and 3 ft (0.9 m) Whip Hose (excluding Contractor FTx).

238-351 Contractor FTx Gun Hose Kit

235-472 Flex Plus Gun Hose Kit

220-962 Contractor Gun Hose Kit

235-473 Silver Plus Gun Hose Kit

238-000 Contractor Gun Hose Kit



Hoses

- Less pressure drop for more performance at the gun
- Upgraded conductive core protects against static charge build-up
- Tough urethane jacket resists abrasion and chemicals for longer life
- Working pressure: 3000 psi (210 bar, 21.0 MPa)

238-360 1/4 in. X 25 ft (6.3 mm X 7.6 m)

238-363 3/8 in. X 50 ft (9.5 mm X 15.2 m)

238-361 1/4 in. X 50 ft (6.3 mm X 15.2 m)

238-785 3/8 in. X 100 ft (9.5 mm X 30 m)

238-387 1/4 in. X 100 ft (6.3 mm X 30 m)

238-358 Whip, 3/16 in. X 3 ft (4.8 mm X 0.9 m)

238-362 3/8 in. X 25 ft (9.5 mm X 7.6 m)

238-359 Whip, 3/16 in. X 6 ft (4.8 mm X 1.8 m)





"We only settle for the best. This includes Graco RAC tips which are simple, convenient to use and are easy to clean out. There isn't another tip that will last longer, either."

Kay Armatage
Armatage Painting
West Jordan, UT

Airless Guns

Contractor FTx™ Gun

238-350 Includes 515 RAC IV SwitchTip and Guard

- Offers Easy Access™, 2-Piece Filter, and built-in Smooth Glide Swivel for top spraying performance
- Trigger pull is 30% lighter than competitors' for easier operation and less fatigue
- Unique paddle-shaped finger latch for quick and simple operation of gun safety and optional trigger lock for cleaning
- 3600 psi (248 bar, 24.8 MPa) max. working pressure
- Fluid Orifice Diameter - 0.125 in. (3.2 mm)



Contractor Gun

220-955 Includes 517 RAC IV SwitchTip and Guard

179-943 Optional 4-Finger Trigger available

- Comfort Grip™, Form-Fitted Handle
- 2-Finger Trigger, Easy Access™, 2-Piece Filter and built-in Smooth Glide Swivel for top spraying performance
- 3600 psi (248 bar, 24.8 MPa) max. working pressure
- Fluid Orifice Diameter - 0.125 in. (3.2 mm)



Silver Plus™ Gun

235-463 2-Finger Trigger with Reverse-A-Clean™ (RAC) IV 517 SwitchTip™ and DripLess™ Tip Guard

235-460 2-Finger Trigger with Flat Tip Guard

235-461 4-Finger Trigger with Flat Tip Guard

235-462 Fine Finish with 2-Finger Trigger and Flat Tip Guard

- Stainless steel fluid tube
- No needle adjustments required, needle guaranteed for life against needle breakage
- 5000 psi (345 bar, 34.5 MPa) max. working pressure
- Fluid Orifice Diameter* - 0.090 in. (2.3 mm)



* Includes all guns except 235-462 which has .037 in. fluid orifice

Pole Guns

- Unmatched spraying performance in high or recessed areas
- Unique full length needle shuts fluid flow off at tip for crisp spray patterns without spitting or waiting
- Includes: Easy Turn™ Directional Spray Head with 180° swivel, RAC IV Tip and Guard

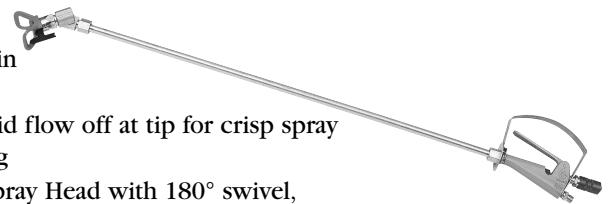

238-311 1 ft (0.3 m)

238-312 2 ft (0.6 m)

238-313 3 ft (0.9 m)

238-314 4 ft (1.2 m)

238-316 6 ft (1.8 m)

238-318 8 ft (2.4 m)

Tip Extensions

- Easily spray hard-to-reach or narrow areas such as soffits, high walls and ceilings
- Unique fitting design and captive gasket allows quick attachment to airless gun or in-line valve
- Includes: Flat Tip Guard standard with 7/8 in. gun nut (fits Graco or Titan guns)
- For Wagner or other guns, order 11/16 in. gun nut adapter, part no. 180-146

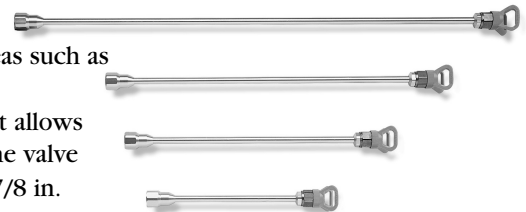

240-040 10 in. (25 cm)

240-041 15 in. (38 cm)

240-042 20 in. (50 cm)

240-043 30 in. (75 cm)

Heavy-Duty Extensions

- Ideal for high or low pressure roller applications or spraying
- Lightest weight aluminum poles available
- Unique fitting design and captive gasket for easy, quick attachment to gun or in-line valve
- Connect in many combinations for desired length
- Standard with 7/8 in. (22 mm) gun nut (fits Graco or Titan guns)
- For Wagner or other guns using 11/16 in. gun nut, order part no. 181-085 gun adapter



232-12	10 in. (25 cm)	232-122	20 in. (50 cm)	232-123	40 in. (100 cm)
232-124	60 in. (150 cm)	232-125	80 in. (200 cm)		

Pressure Roller Attachments

- Connects to airless sprayer for pressure roller applications
- GeoSpurse™ roller head evenly distributes paint across roller cover for a consistent finish

240-054	3 in. (8 cm)
240-005	9 in. (23 cm)
240-055	12 in. (30 cm)

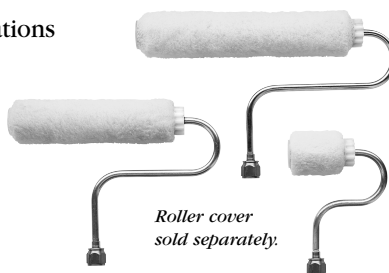

Roller cover sold separately.

Suction Tube Kits

- Adapt suction tube to fit container
- | | |
|---------|---------------------|
| 208-920 | 5 gal. (19 liter) |
| 239-996 | 30 gal. (114 liter) |



Tool Tote™

- Complete storage system for common tools & accessories.
- Easily fastens to any Ultra Max Hi-Boy Model.
- Spacious Compartment* Holds:
 - 5 RAC Tips
 - 1 RAC Performance Series™ Tip Guard
 - 3 Manifold Filters
 - 3 Contractor Gun Filters
 - 2 Adjustable Wrenches
 - 2 Screwdrivers
 - 1 Hammer
 - 1 TSL – 8 oz.
 - Tip Brushes

240-148 Tool Tote Only

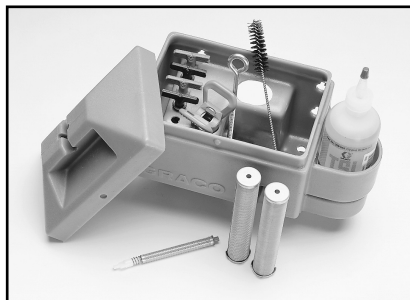

* Tools and Accessories Sold Separately.

Hose Strap

- Secure your hose, power cords and other items for transport or storage.
 - Wraps up to 250 ft (46 m) of 3/4 in. hose!
 - Available in 4-packs.
- 240-296 (4-pack)

“You did it again. I can’t tell you how much your pole guns benefit our production time. I used it on a wood fence to apply Kresote. It worked great and is safer because the applicator isn’t too close to the work. Thanks again for your help in making our application easier and more profitable.”

Mark Mathis
Customer Color Owner
Indianapolis, IN



For the complete offering of Graco accessories, contact your distributor.



Specification Guide

The following is a specification guide to selecting an Ultra Max Airless Sprayer. Always make sure the material you are spraying has been tested for compatibility with your sprayer, and be sure to consult your supplier for specific information.

Part No.	Maximum Tip Size	Maximum Delivery Rating	Maximum Working Pressure	Maximum Hose	Extension Cord
Ultra Max 695 Hi-Boy 232-130 (Bare) 232-131 (Complete)◆	<ul style="list-style-type: none"> 1 gun to 0.026 in. tip 	0.6 gpm (2.3 lpm)	3000 psi (210 bar, 21.0 MPa)	Up to 300 ft (91.4 m)	Up to 300 ft (91.4 m) max. 12AWG 3 wire. Unit includes 15 ft (4.6 m) standard power cord.
Ultra Max 695 Lo-Boy 232-132 (Bare) 232-133 (Complete)◆	<ul style="list-style-type: none"> 1 gun to 0.026 in. tip 	0.6 gpm (2.3 lpm)	3000 psi (210 bar, 21.0 MPa)	Up to 300 ft (91.4 m)	Up to 300 ft (91.4 m) max. 12AWG 3 wire. Unit includes 15 ft (4.6 m) standard power cord.
Ultra Max 795 Hi-Boy 232-140 (Bare) 232-141 (Complete)◆	<ul style="list-style-type: none"> 1 gun to 0.028 in. tip 2 guns to 0.019 in. tip 	0.8 gpm (3 lpm)	3000 psi (210 bar, 21.0 MPa)	Up to 300 ft (91.4 m)	Up to 300 ft (91.4 m) max. 12AWG 3 wire. Unit includes 15 ft (4.6 m) standard power cord.
Ultra Max 1095 Hi-Boy 232-150 (Bare) 232-151 (Complete)◆	<ul style="list-style-type: none"> 1 gun to 0.032 in. tip 2 guns to 0.021 in. tip 	1.1 gpm (4.2 lpm)	3000 psi (210 bar, 21.0 MPa)	Up to 300 ft (91.4 m)	Up to 300 ft (91.4 m) max. 12AWG 3 wire. Unit includes 15 ft (4.6 m) standard power cord.
Ultra Max 1595 Hi-Boy 232-160 (Bare) 232-161 (Complete) 232-162 (Bare, CSA Certified) 232-163 (Complete, CSA Certified)◆	<ul style="list-style-type: none"> 1 gun to 0.035 in. tip 2 guns to 0.025 in. tip 3 guns to 0.019 in. tip 	1.25 gpm (4.75 lpm)	3000 psi (210 bar, 21.0 MPa)	Up to 300 ft (91.4 m)	Up to 300 ft (91.4 m) max. 12AWG 3 wire. Unit includes 15 ft (4.6 m) standard power cord.

Actual performance may vary depending on material viscosity and hose length.

Power Requirements	Motor Size <small>(Produced HP @ 2000 psi (138 bar, 13.8 MPa))</small>	Weight <small>Dry w/o packaging</small>	Dimensions	Pump Repair Kit	Instruction Manual
120 VAC, 60 Hz, 1 phase, 15A min or 3000W generator	.9 HP, DC totally enclosed, fan-cooled	73 lb (33 kg)	L: 21 in. (533 mm) W: 20.5 in. (520 mm) H: 28.5 in. (724 mm)	239-939	308-801
120 VAC, 60 Hz, 1 phase, 15A min or 3000W generator	.9 HP, DC totally enclosed, fan-cooled	61 lb (28 kg)	L: 25.5 in. (648 mm) W: 15 in. (381 mm) H: 20 in. (508 mm)	239-939	308-801
120 VAC, 60 Hz, 1 phase, 15A min or 4000W generator	1.0 HP, DC totally enclosed, fan-cooled	101 lb (46 kg)	L: 25.5 in. (648 mm) W: 20.5 in. (520 mm) H: 28.5 in. (724 mm)	239-928	308-800
120 VAC, 60 Hz, 1 phase, 15A min or 4000W generator	1.2 HP, DC totally enclosed, fan-cooled	107 lb (49 kg)	L: 25.5 in. (648 mm) W: 20.5 in. (521 mm) H: 28.5 in. (724 mm)	239-928	308-799
120 VAC, 60 Hz, 1 phase, 15A min or 5000W generator	1.6 HP, DC totally enclosed, fan-cooled	140 lb (63.5 kg)	L: 22.5 in. (572 mm) W: 22.5 in. (572 mm) H: 30.5 in. (775 mm)	240-248	308-802

◆ Complete sprayers include: 1/4 in. x 50 ft (6.3 mm x 15 m) hose, 3 ft (1m) Whip Hose, and Contractor gun with Reverse-A-Clean™ (RAC) IV 517 SwitchTip™ and DripLess™ Tip Guard.

